



Dear Director,

We are thrilled that your dancers will be competing at the ***Crowd Pleasers Winter Showcase*** this year. We hope that your experience with us will be a rewarding and especially enjoyable start of your contest season. Enclosed you will find information that may be helpful as you make your plans to attend the Winter Showcase on December 5th, 2009. Please feel free to copy any information that you may want to distribute to your team or their parents. **The Performance Schedule will be e-mailed to you Tuesday, December 1stnd, no later than 1:00 pm.** Registration, Payment and Refund Policies are outlined below under Rules and Regulations.

Please note that the **entry number** assigned to each of your entries will be indicated on the schedule and must be printed in black marker on the front of each performance CD. **Also, be aware that the performance schedule may change as much as 30 minutes due to change requests.** An updated schedule will be handed out at the registration table as well as posted at the contest. **Please inform all students and parents of the possibility for schedule changes and remind them to check the most current schedule upon arrival.** Enclosed in this packet are the following:

- * Winter Showcase General Information
- * Crowd Pleasers Regional Showcase General Information, Rules and Regulations
- * Gym and Auditorium Diagrams
- * School Map of Dulles High School
- * Directions to Dulles High School
- * Sample Score Sheets
- * Crowd Pleasers Merchandise Prices
- * Crowd Pleasers Team Patch Order Form
- * Crowd Pleasers Individual Patch Order Form
- * Tour-Rific Of Texas Flyer

If you have any questions please feel free to call us at **800-250-3534**. We look forward to seeing you soon.

Sincerely,

Kay Gabrysch & Kristina Cross

Kay Gabrysch and Kristina Cross

Winter Showcase 2009
General Information

- Event: Winter Showcase
- Date: Saturday, December 5, 2009
- Time: **Saturday**
****Doors open and check-in begin one hour prior to performances****
TBA Performances begin
TBA Awards Ceremony
- Address: Dulles High School
550 Dulles Avenue
Sugar Land, TX 77478
281-634-5600
- Directions: See page 12 of this packet.
- Team Check-In: Team check-in should be accessed through front of the school. After dropping off all passengers, buses should park at the back of the student parking lot near the elementary school. See map on page 11.
- Team Admission: Dance Team members (which include: dancers, escorts, and managers), registered Directors and Assistants, will be permitted to enter free of charge at the team check-in area. Escorts and managers must wear official uniform and must be present when team registers.
- Prop Drop-Off: Prop drop-off area is located in the rear of the school near the gym area. See map on page 11.
- Spectator Admission: **Saturday**
\$10.00 Adults / \$5.00 Senior Citizens / \$5.00 Children (ages 5-12) / Children under 5 are free.
- Spectator Entrance: Spectator entrance should be accessed through the front of the school. This is the same entrance that is used for Team Check-in. Once admission has been paid, spectators may use the "Wristband required" entrance near the gym area. See map on page 10.
- Concessions: Available on site.
No food or drinks may be brought in from outside the building.
- Travel Information: Please contact **Tour-Rific Of Texas** to make hotel or other travel arrangements at **281-587-9555 / 800-829-9505**. See page 18.

Winter Showcase General Info (continued)

Performance Area I:

Performance Area: **Gym I / Main Gym** - see page 9
Sound Area: Back right corner of gym. (Judge's perspective)
Music drop-off: Director or head officer will need to drop off at sound table prior to performance.
**Please note that there will be no music collection table.
Judges Area: Top row and center of bleachers.
Entrance: Front right door of gym (judge's perspective)
Exit: Back right door of gym (judge's perspective)
Floor Surface: Wood floor / regulation basketball and volleyball markings.
Results: Awards ceremony will follow solo finals. Evaluation packets will be available for pick up following the awards ceremony.

Performance Area II:

Performance Area: **Gym II / Small Gym** - see page 9
Sound Area: Back right corner of gym. (Judge's perspective)
Music drop-off: Director or head officer will need to drop off at sound table prior to performance.
**Please note that there will be no music collection table.
Judges Area: On floor in center of bleachers.
Entrance: Front right door of gym. (Judge's perspective)
Exit: Front right door of gym. (Judge's perspective)
Floor Surface: Wood floor / regulation basketball and volleyball markings.
Solo Finals: Will be announced in random performance order shortly after the last solo performance. You will have 10-20 min. to prepare for finals, which will be held in Gym I.
Results: Awards ceremony will follow solo finals. Evaluation packets will be available for pick up following the awards ceremony.

Performance Area III:

Performance Area: **Auditorium** - see page 10
Sound Area: Performer's stage right behind the wings.
Music drop-off: Director or head officer/dancer will need to drop off at sound table prior to performance. **Please note that there will be no music collection table.
Judges Area: Middle section center of row.
Entrance: Performer's stage right.
Exit: Performer's stage right.
Floor Surface and Dimensions: Painted wood floor. Depth is 40 feet. Width is 80 feet.
Solo Finals: Will be announced in random performance order shortly after the last solo performance. You will have 10-20 min. to prepare for finals, which will be held in Gym I.
Results: Awards ceremony will follow solo finals. Evaluation packets will be available for pick up following the awards ceremony.

Crowd Pleasers Regional Showcase

General Information, Rules and Regulations

Solos

- Cost for each entry is \$75
- Time limit: 1.5-2 minutes
- Individuals will be permitted to enter more than one solo (only highest scoring solo may final).
- Solos will be grouped according to grade only by the following guidelines:

Public / Private Schools-

Elementary School / Middle School / HS Jr. 9th-10th / HS Sr. 11th-12th

Community / Studios-

PK-K / Elem. 1st-3rd / Intermediate 4th-6th / Jr. High 7th-9th / HS Sr. 10th-12th

No exceptions will be made for age.

Winter Showcase HS Sr. Solos will also be grouped according style (jazz, lyrical, open).

- Finals will typically consist of the following (we reserve the right to alter these guidelines if necessary):
 - PK-K, Elem., Inter., M.S., Jr. High, Studio HS-Miss Crowd Pleasers Showcase from each age group (performance only)
 - High School Jr. Solos (9th-10th)- Top Scoring 3-10 Dancers compete for final placement
 - High School Sr. Solos (11th-12th)- Top Scoring 5-15 Dancers compete for final placement
- Each participant is only eligible to dance one finals routine regardless of classification.***

-Each Division I solo will be awarded a trophy.

-Three places will be awarded trophies for all age groups. For age groups with 20+ entries, five places will be awarded.

-Cash Scholarships will be awarded to the Top 5 Highest Scoring HS Senior Soloists **at the Winter Showcase only** (minimum of 100 solo entries is required, style will not be considered in determining scholarship winners).

-Only individuals that are members of competitive dance teams will be permitted to enter solos at Team Competitions (does not apply to Winter Showcase). The dance team name will be required upon registering.

Duets / Trios / Small, Medium, and Large Ensembles

-Cost for each entry is as follows:

Duets	\$120	Med. Ens. (7-12)	\$130
Trios	\$130	Large Ens. (13-20)	\$140
Sm. Ens. (4-6)	\$140		

-Time limit: 1.5-2.5 minutes excluding entrance and exit.

-Entries are grouped according to the following guidelines:

Public / Private Schools-

Elementary School / Middle School / High School

Community / Studios-

PK-K / Elem. K-3rd / Inter. 4th-6th / Jr. High 7th-9th / HS 9th-12th

-Each Division I performance will be awarded patches for all participants.

-Within each category and age group the top three places will be awarded trophies. For age groups with 20+ entries for any of the above entry types, five places will be awarded.

Social Officer Routines

- Cost for each entry is \$150
- Time limit: 1.5-2.5 minutes excluding entrance and exit.
- Must consist of Social Officers only.
- Entries are grouped according to the following guidelines:
 - Public / Private Schools-**
Elementary School / Middle School / High School
 - Community / Studios-**
PK-K / Elem. K-3rd / Inter. 4th-6th / Jr. High 7th-9th / HS 9th-12th
- Each Division I performance will be awarded patches for all participants.
- Within each age group the top three places will be awarded trophies.

Dance Officer Routines

- Cost for each entry is \$170
- Time limit: 1.5-3 minutes excluding entrance and exit.
- Should your entrance and exit exceed a total of 2 minutes, please contact our office to make special scheduling arrangements **one week prior to the contest.**
- Must consist of Dance Officers only.
- Entries are grouped according to the following guidelines:
 - Public / Private Schools-**
Elementary School / Middle School / High School JV 9th grade + / High School Varsity
 - Community / Studios-**
PK-K / Elem. K-3rd / Inter. 4th-6th / Jr. High 7th-9th / HS 9th-12th
- High School Varsity entries may be grouped according to **team membership** size depending on the number of entries in each age group (not applicable for Winter Showcase).
- Within each group you may enter the following styles (For the purpose of the Overall Merit Awards, P indicates Precision Styles / T indicates Technical Styles):

Jazz (T)	Pom (P)	Prop (P)	Lyrical (T)	Hip Hop (T)	Contemporary (T)
Kick (P)	Military (P)	Novelty (P)	Modern (T)	Open (T/P)	
- Each Division I performance will be awarded patches for all participants.
- Silver Sweepstakes trophies will be awarded to those officer groups receiving an Avg. of 85+ on two routines.
- Within each group a "Best in Class" will be chosen for each style of routine. A score of 90+ is required for this award to be given. Three places will be awarded for categories with 5+ entries.
- All entries are eligible for the following:

Outstanding Technique	(High scores in technique)
Outstanding Choreography	(High scores in choreography)
Crowd Pleasers	(Audience appeal)
- You must enter three Officer Routines to be eligible for each of the following within your group (awards indicated with "*" are not applicable for Winter Showcase):

Gold Sweepstakes	(Avg. score 85+)
Super Sweepstakes	(Avg. score 90+)
Overall Technical Merit	(Highest Avg. score, 90+, in 2+ Technical Styles as indicated above)
Overall Precision Merit	(Highest Avg. score, 90+, in 2+ Precision Styles as indicated above)
2 nd Runner Up	(3 rd Highest Avg. Score, 90+, requires 5+ teams in group)
1 st Runner Up	(2 nd Highest Avg. Score, 90+, requires 5+ teams in group)
Grand Champion	(Highest Avg. Score, 90+)
*Showcase Elite	(Top Scoring Officer Groups)

-If entering 4+ officer routines, only top 3 scoring routines will count towards final average score.

Team Routines (not applicable for Winter Showcase)

- Cost for each entry is \$200
- Time limit: 1.5-3 minutes excluding entrance and exit.
- Should your entrance and exit exceed a total of 2 minutes, please contact our office to make special scheduling arrangements **one week prior to the contest.**
- Entries are grouped according to the following guidelines:
 - Public / Private Schools-**
Elementary School / Middle School / High School JV 9th grade + / High School Elite / High School Varsity
 - Community / Studios-**
PK-K / Elem. K-3rd / Inter. 4th-6th / Jr. High 7th-9th / HS 9th-12th
- High School Elite groups should consist of up to 24 members of your team that wish to enter as a separate Elite team in order to compete against the Elite teams from other schools. Elite teams may not consist of only officers. You must enter 3+ Elite team routines in order to be eligible for the overall awards listed below.
- High School Varsity entries will be further grouped according to **team membership** size by the following guidelines:
 - Small Team (up to 20) Large Team (41-60)
 - Medium Team (21-40) X-Large Team (61+)
- JV Team Entries are all grouped together regardless of team size.
- We do not require that a minimum % of your team members dance, but we do require a minimum of 6 girls to be dancing to enter as a team.
- No changes in team size will be permitted after the Friday one week prior to the contest.
- Within each group you may enter the following styles (For the purpose of the Overall Merit Awards, P indicates Precision Styles / T indicates Technical Styles):

Jazz (T)	Pom (P)	Prop (P)	Lyrical (T)	Hip Hop (T)	Contemporary (T)
Kick (P)	Military (P)	Novelty (P)	Modern (T)	Open (T/P)	
- Division I trophies will be awarded to those teams receiving 85+ on one routine.
- Silver Sweepstakes trophies will be awarded to those teams receiving an Avg. of 85+ on two routines.
- Within each group a "Best in Class" will be chosen for each style of routine. A score of 90+ is required for this award to be given. Three places will be awarded for categories with 5 or more entries.
- In the HS Division an Overall Most Outstanding award will be chosen for each style of routine with 8+ entries.
- All entries are eligible for the following:

Outstanding Technique	(High scores in technique)
Outstanding Choreography	(High scores in choreography)
Crowd Pleasers	(Audience appeal)
- You must enter three Team Routines to be eligible for each of the following within your group:

Gold Sweepstakes	(Avg. score 85+)
Super Sweepstakes	(Avg. score 90+)
Overall Technical Merit	(Highest Avg. score, 90+, in 2+ Technical Styles as indicated above)
Overall Precision Merit	(Highest Avg. score, 90+, in 2+ Precision Styles as indicated above)
2 nd Runner Up	(3 rd Highest Avg. Score, 90+)
1 st Runner Up	(2 nd Highest Avg. Score, 90+)
Grand Champion	(Highest Avg. Score, 90+, \$200 Cash Prizes Awarded to qualified Public School Programs)
Showcase Elite	(Top Scoring Teams)
Overall Grand Champion	(\$500 Cash Prize Awarded to qualified Public School Programs)
- If entering 4+ team routines, only top 3 scoring routines will count towards final average score.

Team Production

- Cost for each entry is \$250
- Time limit: 4-6 minutes excluding entrance and exit
- Should your entrance and exit exceed a total of 4 minutes, please contact us to make special scheduling arrangements **one week prior to the contest.**
- Entries in this category count towards eligibility for above Team awards.
- Team routine guideline for groupings apply.
- Within each group Team Production "Best in Class" will be chosen.

Music

- Must be professionally recorded on a **clean, high quality CD**. Please be sure to have a back up copy on hand.
- **Please label with your name, entry number (available on performance schedule), and school name.** (one routine per CD)
- You may also play music from an MP3 player with a 1/8 in. ear phone jack. Please plan to have a representative at the music table to operate your MP3 player to avoid and confusion. Please also be sure you have a cd as back-up.
- Please make every effort to have music recorded at the proper tempo. If necessary, speed checks will be done just prior to performance at music table.
- CD's that have not been picked up by the end of the contest will be returned to you in your evaluation packet.

Performance Schedule

- Performance **schedule will be e-mailed to you the Tuesday prior to the contest no later than 1:00 pm**. If you would like to receive your schedule by fax please call our office to make arrangements.
- The schedule will be posted on our website as well the Thursday prior to the contest after directors have had the opportunity to request changes.
- The schedule you receive may run as much as 30 min. ahead or behind. Please notify all potential spectators of this possibility. You will also receive the updated schedule upon registration.
- Schedule changes must be requested in writing via email.
- No emailed changes will be accepted after 5:00 pm the Wednesday before the day of the contest.**
- Late changes must be submitted on the Change Request form upon check-in at the contest.**

Poms, Props and Backdrops

- If you use poms or props that shed, please have a team representative scheduled to clean the floor following performance.
- Please be sure to pad (foam, felt, tape) the bottom of all wooden/metal props. You will be responsible for any damage to the gym floor due to improperly padded props. Directors may be asked to sign a contract with the host school acknowledging and agreeing to their property damage policies.
- No hard soled boots or shoes will be permitted on the gym floor. You may not tap or clog directly on gym floor. You will be responsible for providing padded tap boards/flooring.
- Curtains, staging, and other props should be constructed to fit through a 7 foot tall double door with the center support bar removed.
- Because only 5 minutes (10 mins. for Productions) is allotted for each team routine (including entrance, set up, tear down and exit) only minimal set up is allowed on the floor. Any exceptions must be approved at least 1weeks prior to the competition.

Dressing Areas

- Will be assigned the morning of the contest upon check-in.
- As a general rule men will not be permitted in dressing rooms. Should you have male team members, please contact our office one week prior and we will be happy to make special dressing room arrangements.
- No food or drinks will be allowed in dressing rooms.
- Dressing areas may be shared by several schools. Please be courteous and display good sportsmanship at all times.

Videography / Photography

- A videographer will be on site to record all performances in both gyms at select contests only. A booth will be set up all day for you to place video orders.
- Personal videotaping will be permitted. However, no electrical outlets will be available for personal use and tripods are strictly prohibited. Thank you for your cooperation on this matter.
- A photographer will be on site to take team and candid photos following each performance. Packages will be available for you to order.

Spectator Fees and Comps

- Spectator fees will be as follows:
 - Friday only (if applicable)- \$5 Adults / Senior Citizens and Children are free
 - Saturday only- \$10 Adults / \$5 Senior Citizens / \$5 Children (ages 5-12) / Under 5 free
 - Two Day Pass (if applicable)- \$13 Adults
- Each Team will be given name badges for 1 Director and 1 Assistant (names must be indicated on registration).
- At Winter Showcase, only teams entering medium or large ensembles and/or officer routines will receive complimentary passes for chaperones.
- At All Regional Team Competitions each team competing in team events will receive 3 complimentary passes available for pick-up at Team Check-in.

Registration, Payment and Refund Policies

- All registrations must be submitted online.
- Registrations received after the posted deadlines are subject to a \$75 late fee.
- We will not schedule performances until payment has been received in full.
- Drops and adds to the original registration must be received in writing via email or fax no later than 10 days prior to the event.
- You will be responsible for payment of all entries on your original registration unless you comply with the Drop policy stated above.

Miscellaneous Information

- In an effort to promote a wholesome contest environment that can be enjoyed by family members of all ages, Crowd Pleasers will support its judges in the deduction of points for *inappropriate music, costuming, or movement*. Please note that these deductions may affect your final standings for all categories. These point deductions will be clearly indicated in the "CP Style?" box on the bottom of each score sheet.
- In an effort to support our gracious host schools, absolutely NO outside food or drinks will be allowed on campus.
- Crowd Pleasers cannot be responsible for shipping awards or score packets that are left at the contest site. Should you leave them behind, arrangements for pick up must be made with the host school.
- There will be a Lost and Found / First Aid station set up outside the main gym.
- Band-Aids, wrapping tape, ice and minor first aid items will be available.
- No medication of any sort will be given out.

PERFORMANCE AREA I – GYM I

Spectator Seating & Judges

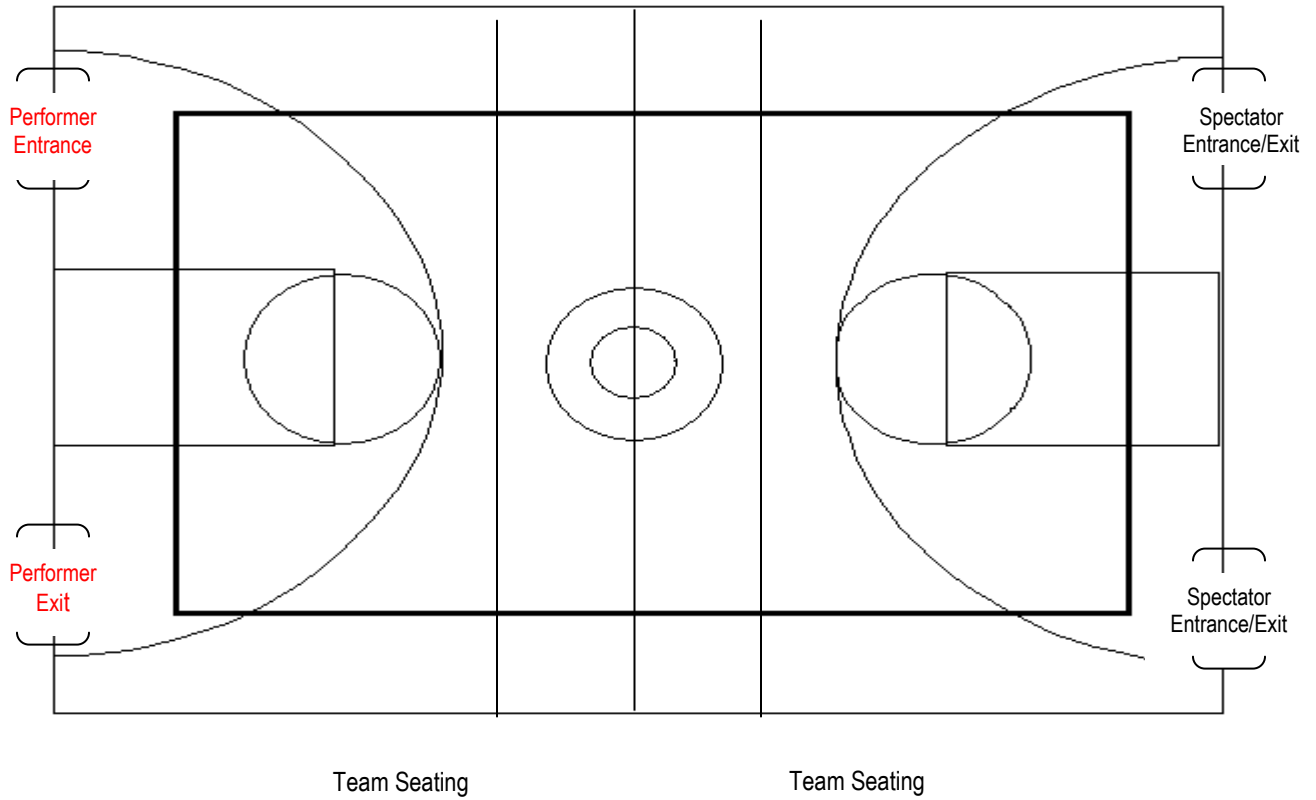

PERFORMANCE AREA II – GYM II

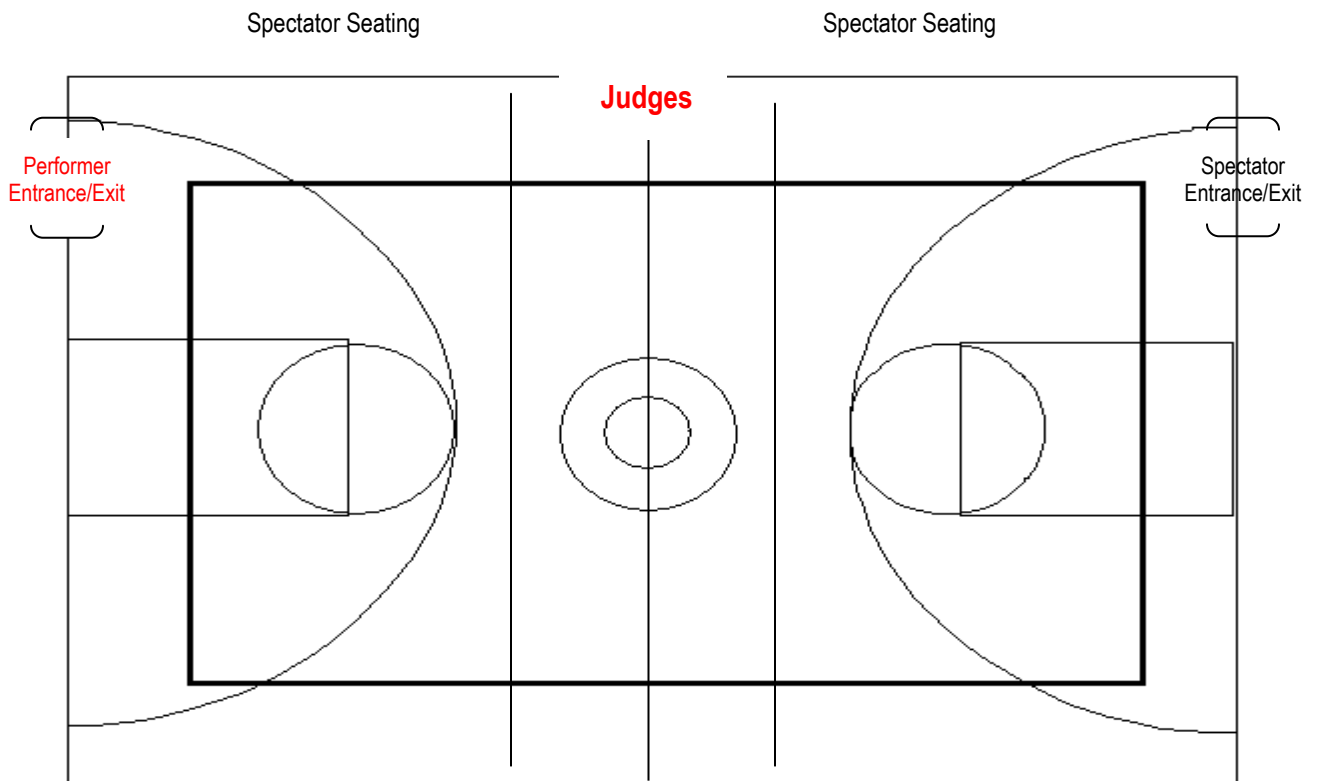

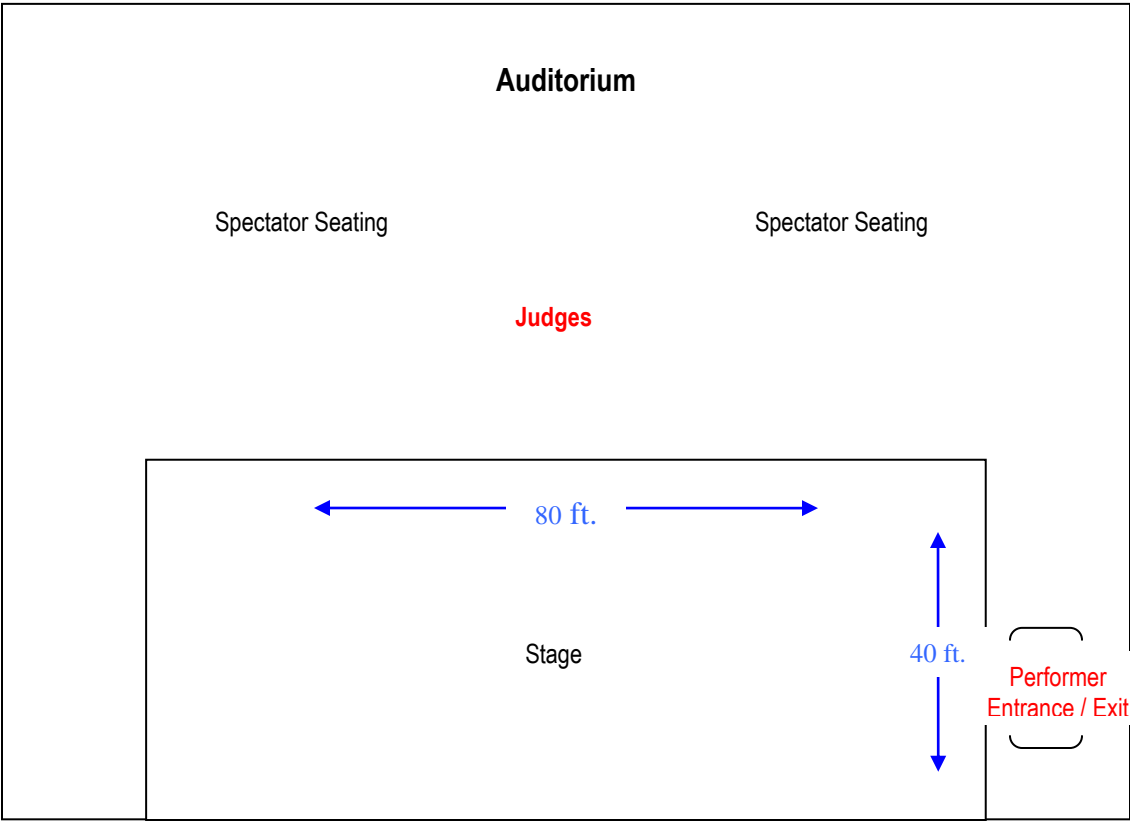

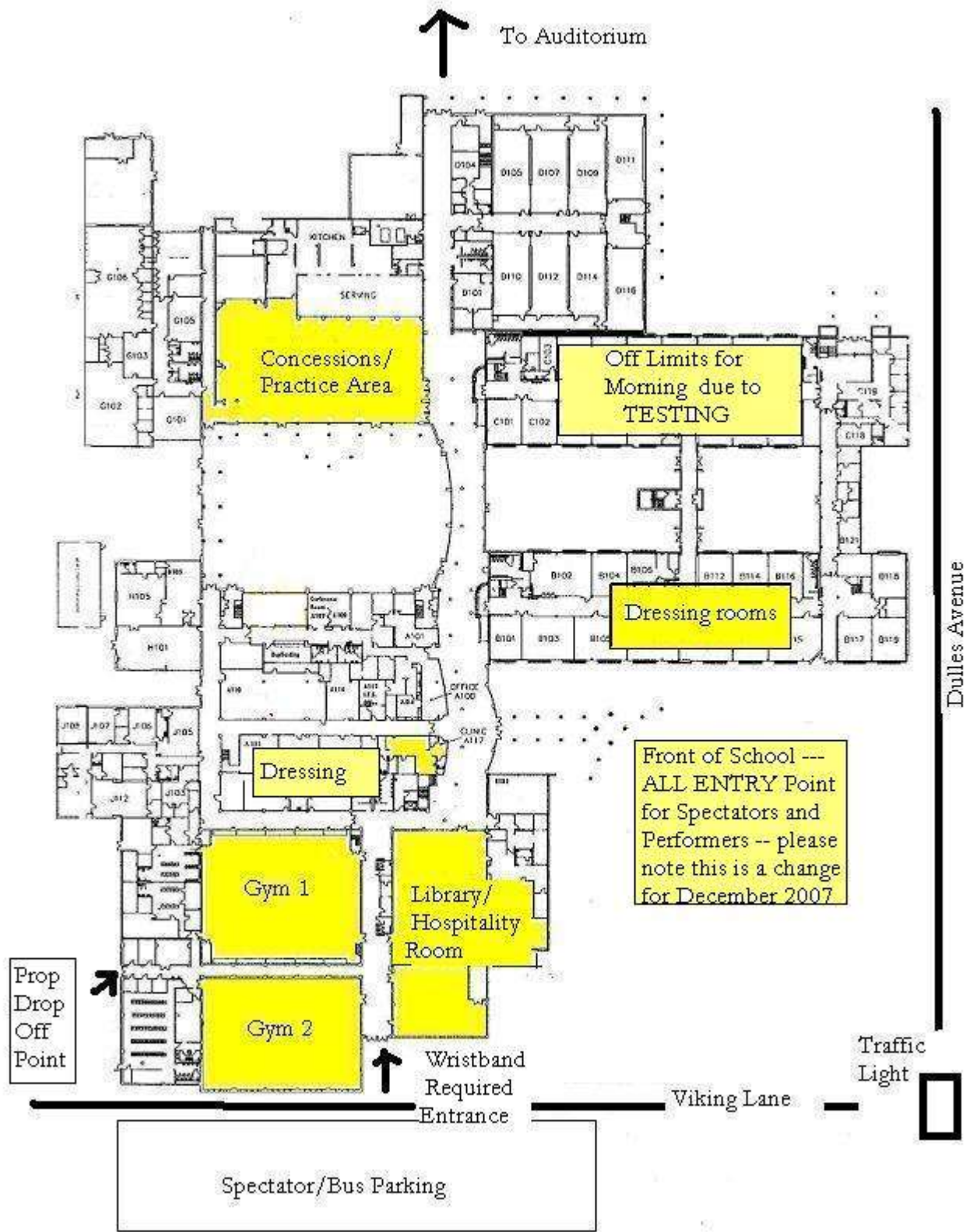

Dulles High School
550 Dulles Avenue
Sugar Land, Texas 77478

Winter Showcase
Directions to Dulles High School

From the Houston Area

Travel South bound on Highway 59.

Exit Airport/Kirkwood and take the second left on Kirkwood.

As Kirkwood crosses over Hwy 90, the road is “renamed” Dulles Avenue.

The physical location of the school is 550 Dulles Avenue and the building complexes will be on the right.

At the traffic light/intersection, turn right onto Viking Lane into campus complex.

The main parking lot will be on the left and entrance to the gym area will be on the right.

**For team entrance and prop drop off - travel on Viking Lane as it turns right behind the school and the drop off point will be right there.

From Dallas

Take I-45 North toward Houston.

Approaching the Houston area, take Exit #60B/TX-8 Sam Houston Tollway onto Beltway 8.

Take the Bellaire Blvd. exit onto W Sam Houston Parkway S.

Continue on ramp and continue on Bellaire Blvd.

Turn left on S Kirkwood.

S Kirkwood becomes Dulles Avenue.

The physical location of the school is 550 Dulles Avenue and the building complexes will be on the right.

At the traffic light/intersection, turn right onto Viking Lane into campus complex.

The main parking lot will be on the left and entrance to the gym area will be on the right.

**For team entrance and prop drop off - travel on Viking Lane as it turns right behind the school and the drop off point will be right there.

From Austin

Take US-290 toward Houston.

Approaching the Houston area, take the Northwest Freeway/Houston exit onto W Beltway 8.

Take the US-59 exit.

Take the TX-41/US Hwy 90 ALT/Sugar Creek Blvd. exit onto SW Freeway toward Sugar Land.

Bear right on Ramp and continue on St. Spur 41.

Turn Right on US-90 Alt.

Turn Right on Dulles Avenue.

The physical location of the school is 550 Dulles Avenue and the building complexes will be on the right.

At the traffic light/intersection, turn right onto Viking Lane into campus complex.

The main parking lot will be on the left and entrance to the gym area will be on the right.

**For team entrance and prop drop off - travel on Viking Lane as it turns right behind the school and the drop off point will be right there.

Dulles High School

Director: Angela Hayes

550 Dulles Avenue

Sugar Land, TX 77478

281-634-5716

angela.hayes@fortbend.k12.tx.us

Entry #



Solo/Ensemble Sample Score Sheet

This sheet is for scoring purposes only. Please refer to talk tapes for critiques.

Choreography- (25 points) _____ / **25 pts.**

Creativity	Originality	Variety	Continuity
Use of Levels	Use of Space	Formations	Transitions
Difficulty	Musical Interpretation	Use of Props (if applicable)	Use of Theme (if applicable)

Technique- (25 points) _____ / **25 pts.**

Extension	Control	Flexibility	Completion of Movement
Turns	Leaps	Tricks	Kicks
Placement of:	Head / Arms / Hands / Legs / Feet / Body		

Execution- (25 points) _____ / **25 pts.**

Memory	Precision	Alignment	Facings
Timing	Rhythm	Dynamics	Spacing

Showmanship- (20 points) _____ / **20 pts.**

Projection	Expression	Personality	Confidence
Body Carriage	Energy Level	Presence	

Appearance- (5 points) _____ / **5 pts.**

Makeup	Posture	Grooming	Uniformity
--------	---------	----------	------------

Overall Deductions for CP Appropriateness

-1	-2	-3
-----------	-----------	-----------

Deductions at judge's discretion due to the following:

Music	Costume
Movement	

Total Score pts.

85-100-	I
70-84-	II
56-69-	III

Judge: _____

Entry #



Team/Officer Sample Score Sheet

This sheet is for scoring purposes only. Please refer to talk tapes for critiques.

Overall Difficulty - (5 points)

_____ / **5 pts.**

Choreography- (20 points)

_____ / **20 pts.**

Creativity	Originality	Variety	Continuity
Use of Levels	Use of Space	Formations	Transitions
Difficulty	Musical Interpretation	Use of Props (if applicable)	Use of Theme (if applicable)

Technique- (25 points)

_____ / **25 pts.**

Extension	Control	Flexibility	Completion of Movement
Turns	Leaps	Tricks	Kicks
Placement of:	Head / Arms / Hands / Legs / Feet / Body		

Execution- (25 points)

_____ / **25 pts.**

Memory	Precision	Alignment	Facings
Timing	Rhythm	Dynamics	Spacing

Showmanship- (20 points)

_____ / **20 pts.**

Projection	Expression	Personality	Confidence
Body Carriage	Energy Level	Presence	

Appearance- (5 points)

_____ / **5 pts.**

Makeup	Posture	Grooming	Uniformity
--------	---------	----------	------------

Overall Deductions for CP Appropriateness

-1 -2 -3

Deductions at judge's discretion due to the following:

Music	Costume
Movement	

Total Score _____ **pts.**

85-100-	I
70-84-	II
56-69-	III

Judge: _____

Crowd Pleasers Merchandise Pricing 2009

Specialty Apparel	\$18.00 - \$25.00
Jackets	\$25.00
Hooded Sweatshirts	\$25.00
Dance Pants	\$20.00
Long Sleeves	\$18.00
Tanks / Fitted Shirts	\$16.00
Regular T-Shirt	\$15.00
Event Patch	\$5.00
Achievement Patch	\$3.00

*Buy 2 of any apparel = \$5.00 off

*Buy 3 of any apparel = \$8.00 off

*Apparel is all shirts, pants and jackets ONLY.

Crowd Pleasers Dance Camps, Inc.
Team Patch Order Form

Patch Description	Quantity		Price		Total
National Contest Patch		X	\$5.00	=	
General Contest Patch		X	\$5.00	=	
Winter Showcase Patch		X	\$5.00	=	
Division I Patch		X	\$3.00	=	
Silver Sweepstakes Patch		X	\$3.00	=	
Gold Sweepstakes Patch		X	\$3.00	=	
Super Sweepstakes Patch		X	\$3.00	=	
Outstanding Showmanship Patch		X	\$3.00	=	
Outstanding Choreography Patch		X	\$3.00	=	
Outstanding Technique Patch		X	\$3.00	=	
Best In Class Patch		X	\$3.00	=	
Showcase Elite Patch		X	\$3.00	=	
Grand Champion Patch		X	\$3.00	=	
Solo Finalist Patch		X	\$3.00	=	

Sub Total _____
Shipping + 10.00
*Total** _____

*Please make checks payable to Crowd Pleasers.

Please Mail to: **Crowd Pleasers Dance Camps, Inc.**
P.O. Box 93505
Southlake, TX 76092

School Address: _____

Director E-mail: _____

Crowd Pleasers Dance Camps, Inc.
Individual Patch Order Form

Patch Description	Quantity		Price		Total
National Contest Patch		X	\$5.00	=	
General Contest Patch		X	\$5.00	=	
Winter Showcase Patch		X	\$5.00	=	
Division I Patch		X	\$3.00	=	
Silver Sweepstakes Patch		X	\$3.00	=	
Gold Sweepstakes		X	\$3.00	=	
Super Sweepstakes Patch		X	\$3.00	=	
Outstanding Showmanship Patch		X	\$3.00	=	
Outstanding Choreography Patch		X	\$3.00	=	
Outstanding Technique Patch		X	\$3.00	=	
Best In Class Patch		X	\$3.00	=	
Showcase Elite Patch		X	\$3.00	=	
Grand Champion Patch		X	\$3.00	=	
Solo Finalist Patch		X	\$3.00	=	

Sub Total _____
Shipping + _____
(10% of subtotal)
*Total** _____

***Please make checks payable to Crowd Pleasers.**
Please Mail to: Crowd Pleasers Dance Camps, Inc.
P.O. Box 93505
Southlake, TX 76092

Mail Merchandise to: _____

E-mail: _____



TOUR-RIFIC® of Texas

13810 Champion Forest Drive, Suite 200

Houston, Texas 77069

281-587-9555 / FAX 281-587-9994

To Save Time

To Save Money

For All The Extras

Call Tour-Rific of Texas

For Affordable, Custom Travel

At ***Tour-Rific of Texas***, we know your time is limited, and the details of group travel can easily become overwhelming. Relying on the *team travel professionals* at ***Tour-Rific of Texas*** saves you countless headaches and ensures that your trip will be a success. We specialize in organizing group trips that emphasize fun and entertaining activities, seasonal events and great meals.

Every trip arranged by ***Tour-Rific of Texas*** is carefully tailored to the group's needs and budget. We offer the lowest prices for airfare, charter bus service, deluxe hotels, group meals, attraction tickets and sightseeing tours, while maintaining the highest of standards from our vendors.

With ***Tour-Rific of Texas*** you will receive personalized service from beginning to end. Sample student letters, rules and contracts outline student financial and behavioral responsibilities that the group leader can customize. Optional group or individual trip insurance is available. The group leader will receive written instructions with detailed itinerary, charter numbers, contact names and numbers. A booster club or school presentation in the greater Houston area is available subject to operator availability. Your groups' trip deposits are protected in a customer trust account.

Call today for your no obligation trip proposal – 281-587-9555/ 800-829-9505.

Professional Affiliations: *TDEA / Texas Dance Educators Association, SYTA / Student Youth Travel Association, NTA / National Tour Association, ABA / American Bus Association and the Disney Youth Travel Planner Advisory Board*

Tour-Rific of Texas is not affiliated with Crowd Pleasers and gives no compensation to Crowd Pleasers for their referral.

“Team Travel Is An Investment In Memories”